

Succulent Terrace I Succulent Terrace II

- | | |
|------------------------------|-------------------------------|
| 1 Echinopsis sp. | 1 Drosanthemum sp. |
| 2 Portulacaria afra | 2 Cotyledon orbiculata |
| 3 Aeonium arboreum | 3 Oreopanax capitatus |
| Atropurpureum' or 'Zwartkop' | 4 Haemanthus coccineus |
| 6 Aloe sp. | 5 Arum pictum |
| 7 Acanthus mollis | 6 Senecio ficoides |
| 8 Yucca elephantipes | 7 Crassula ovata |
| 9 Cotyledon orbiculata | 9 Aeonium haworthii |
| 10 Agave victoria-reginae | 10 Crassula sp. |
| 11 Drosanthemum sp. | 11 Agave ? |
| 13 Cotyledon | 12 Aeonium arboreum |
| 16 Aeonium haworthii | 'Atropurpureum' or 'Zwartkop' |
| 17 Kleinia ficoides | 13 Aloe arborescens |
| 18 Crocosmia | 14 Scilla hyacinthoides |
| 19 Cercis siliquastrum | 15 Sedum ochroleucum |
| 4, 5, 12 Sedum sp. | 16 Senecio fulgens |
| | 17 Sedum sp. |

Succulent Terrace III

- | | |
|-----------------------------|----------------------------------|
| 1 Acanthus mollis | 20 Artemisia arborescens |
| 2 Olea europea | 21 Ruta graveolens |
| 3 Eriosephalus africanus | 22 Quercus coccifera |
| 4 Lavandula dentata | 23 Lomelosia cretica |
| 5 Cotyledon orbiculata | 24 Teucrium fruticans 'Azureum' |
| 6 Iris germanica | 25 Convolvulus cneorum |
| 7 Pelargonium quercifolium | 26 Cneorum tricoccon |
| 8 Tecoma capensis 'Apricot' | 27 Ptilostemon chamaepeuce |
| 9 Spirea x vanhouteii | 28 Limoniastrum monopetalum |
| 10 Salvia discolor | 29 Ballota acetabulosa |
| 11 Rosmarinus officinalis | 30 Ferraria crista |
| 12 Euryops pectinatus | 31 Aloe maculata |
| 13 Phlomis fruticosa | 32 Aloe hybrid |
| 14 Cheiranthus cheiri | 33 Eriogonum fasciculatum 'Dana' |
| 15 Clematis vitalba | 34 Echium candicans |
| 16 Euphorbia characias | 35 Iris unguicularis |
| 17 Salvia chamaedryoides | 36 Pelargonium |
| 18 Tradescantia pallida | 37 Drimia maritima |
| 19 Rosmarinus repens | |
| 20 Artemisia arborescens | |

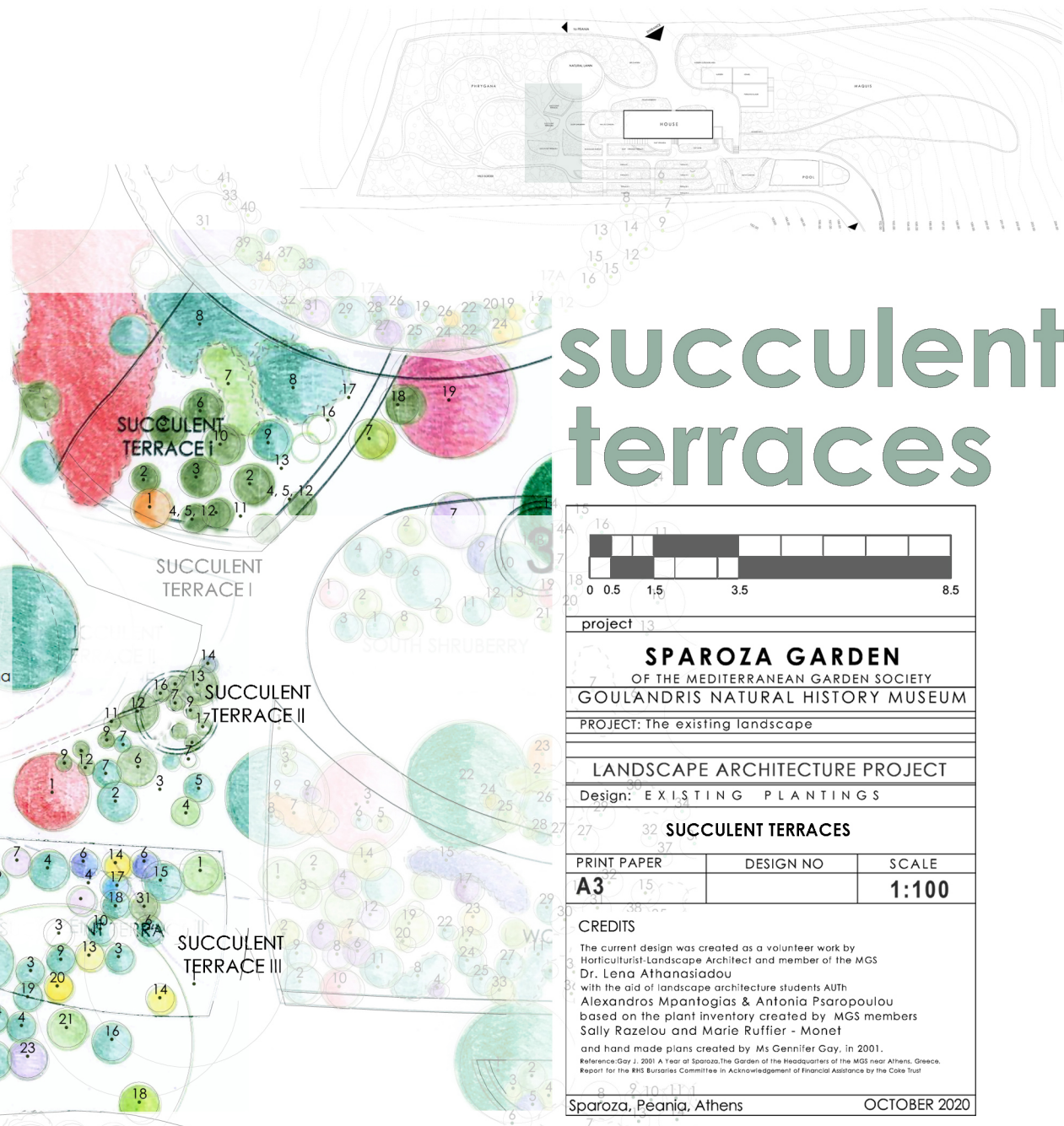

*coloring of map indicating spring flowering colors